

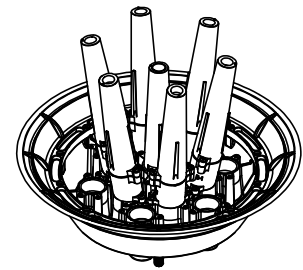

Fusion Series: LILY

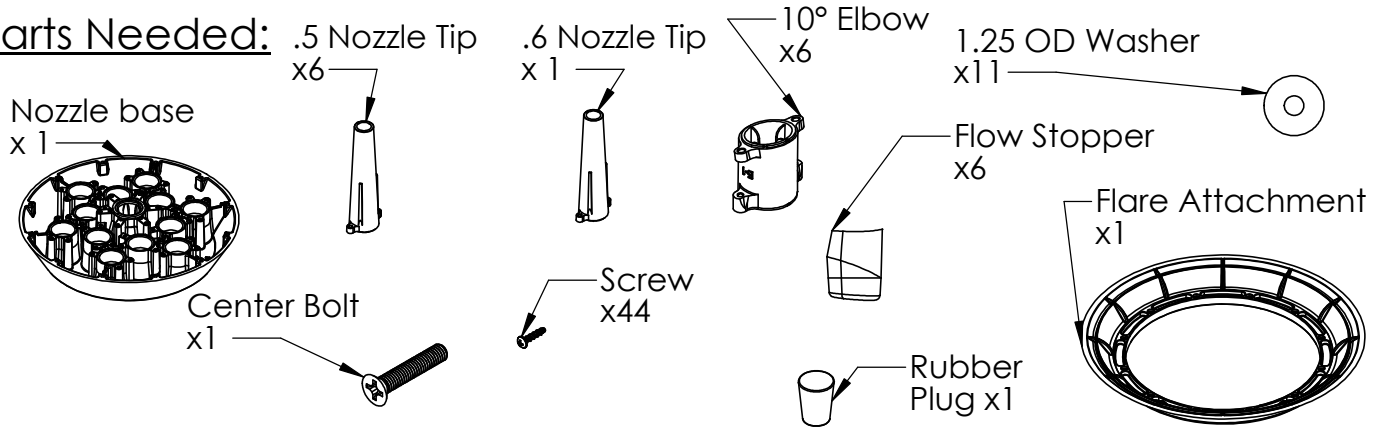

Parts Needed:



1. Assemble Nozzle Groups:

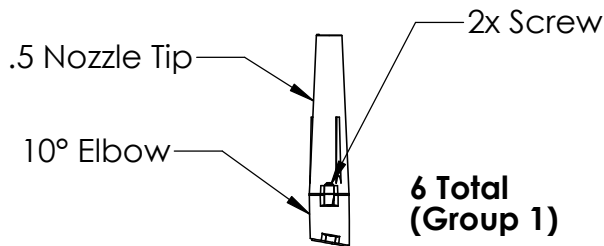

2. Install Flare:

(flare is shipped upside down, remove first)

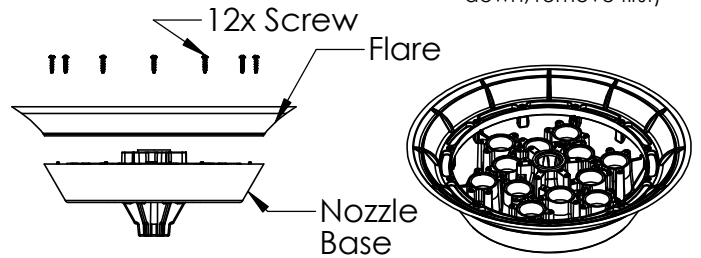

3. Install Nozzle Groups to Base

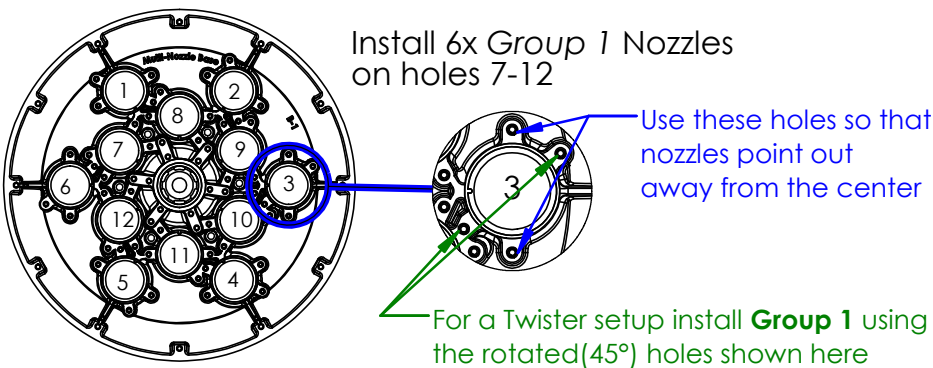

4. Install Flow Stopper

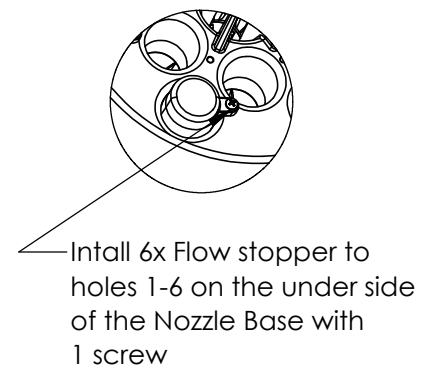

5. Add Washers to the Cup



Finally attach the plugged .6 Nozzle Tip to the center of the Nozzle Base using 2 screws

