

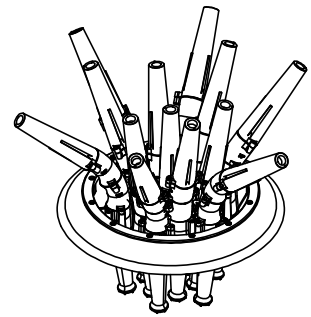

# ***Fusion Series: PENTALATOR***

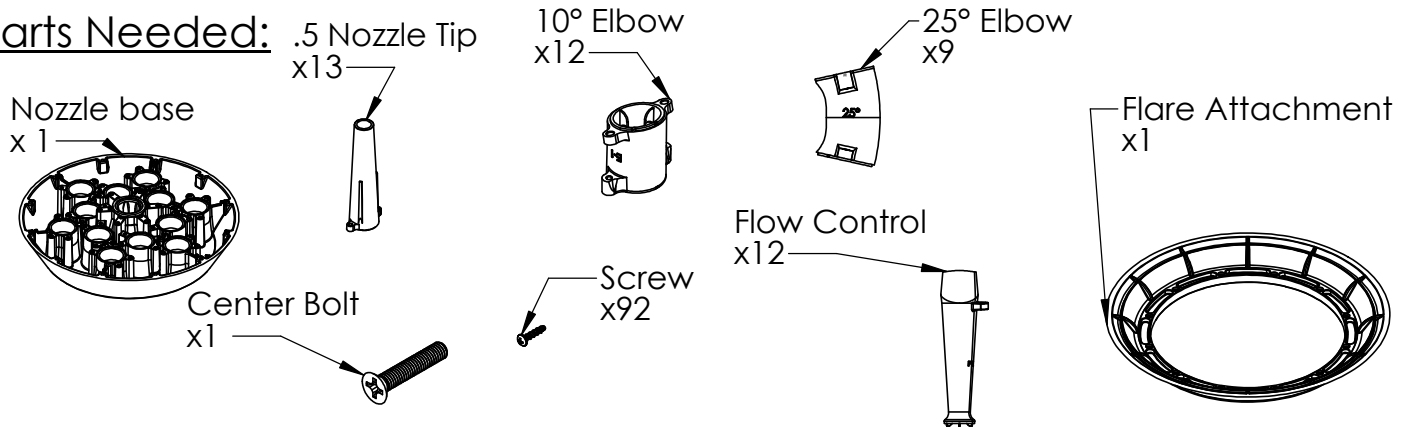

## Parts Needed:



## 1. Assemble Nozzle Groups:

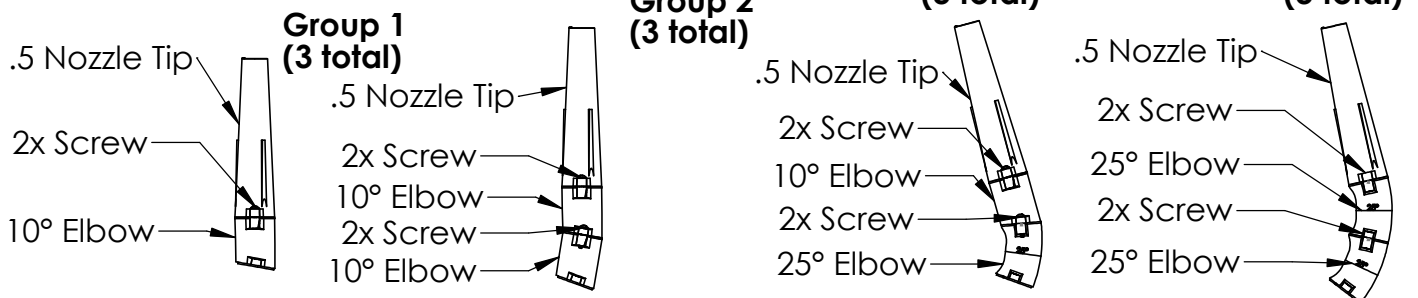

## 2. Install Flare:

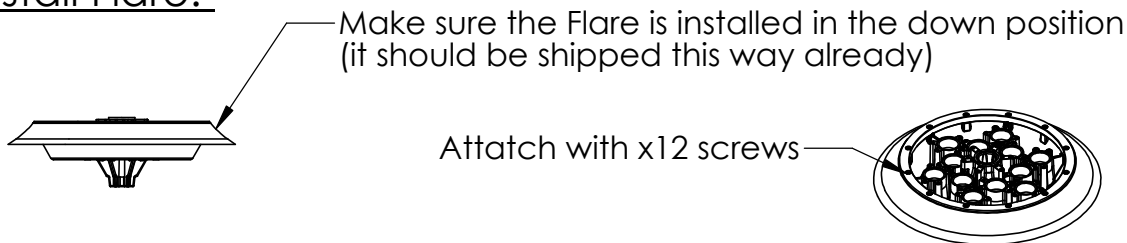

## 3. Install Nozzle Groups to Base

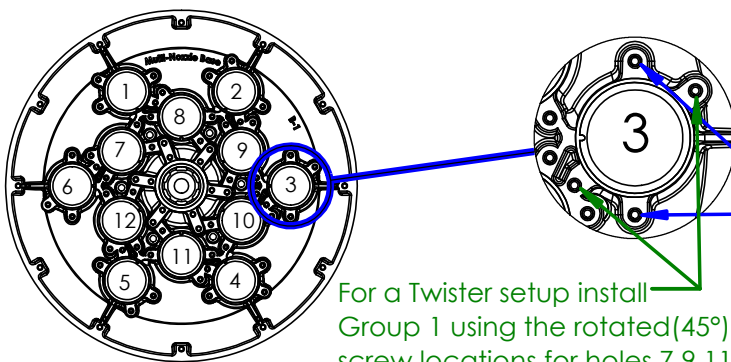

- Install 3x **Group 1** Nozzles on holes 7,9,11
- Install 3x **Group 2** Nozzles on holes 8,10,12
- Install 3x **Group 3** Nozzles on holes 1,3,5
- Install 3x **Group 4** Nozzles on holes 2,4,6

Use these holes so that nozzles point out away from the center



## ***Fusion Series: Pentalator***

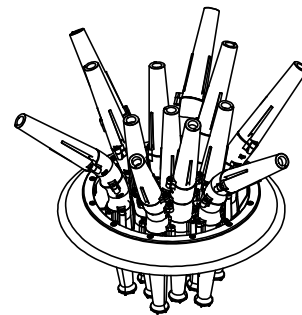

### 4. Install Flow Controls

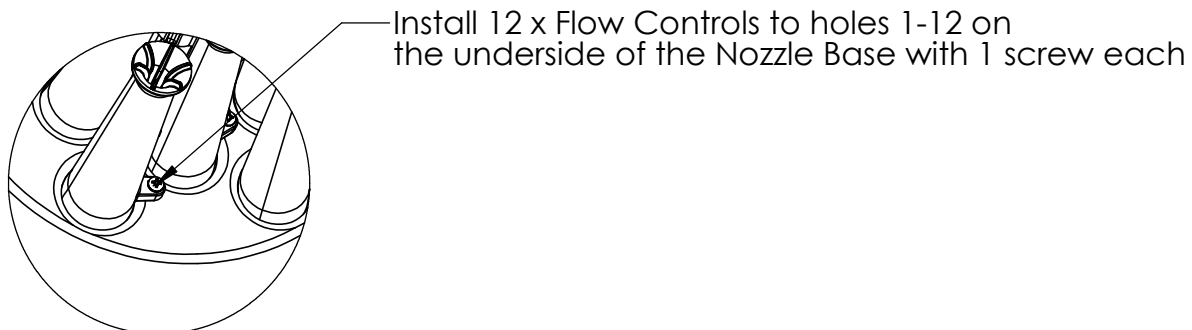

### 5. Attatch Nozzle Base to the Unit

Next place the Nozzle Base on the Outflow and secure with the center bolt

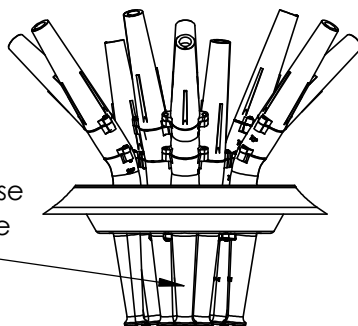

Finally attach the .5 Nozzle Tip to the center of the Nozzle Base using 2 screws

